

__LastSelection

type of gearhead: all coaxial gearheads

shape of output: smooth shaft

gear backlash from: 1 arcmin to 12 arcmin

use: general operation

mountability: gearhead fits to selected motor

Application: mountable to application

gearhead design: planetary gearheads

no. of outputs: one output shaft/flange

utilisation from: 70% to 120%

ratio from: 100 to 100

type of gearhead: LP+

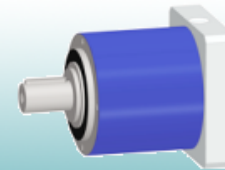

update

OK	Typ	a(Gesamt)	Ver	i	s	D6	J1	T2B	a(T2B)	T2N	a(T2N)	T2Not	n1Max	a(n1Max)	n1Nenn	a(n1)	cT21	cK2	Spiel	FqMax	a(F)	FaMax	a(FaMax)	M2K	a(M2K)	eta
	[]	[%]	[-]	[1]	[1]	[mm]	[kgcm1]	[Nm]	[%]	[Nm]	[%]	[Nm]	[U/min]	[%]	[U/min]	[%]	[Nm/arc	[Nm/arc	[arcmin]	[N]	[%]	[N]	[%]	[Nm]	[%]	[1]
all	filter	all	all	all	all	all	all	all	all	all	all	all	all	all	all	a	all	all	all	all	all	all	all	all	all	all
231	LP+070	1	M	3	1	16	0,3	32	1	16,5	1	65	6000	1	3700	1	2,8	-1	12,0/8,0	1450	1	1550	1	61,6	1	0,9
232	LP+070	1	M	4	1	16	0,25	35	1	18	1	75	6000	1	3700	1	3,3	-1	12,0/8,0	1450	1	1550	1	61,6	1	0,9
233	LP+070	1	M	5	1	16	0,23	35	1	18	1	75	6000	1	3700	1	3,3	-1	12,0/8,0	1450	1	1550	1	61,6	1	0,9
234	LP+070	1	M	7	1	16	0,22	35	1	18	1	75	6000	1	3700	1	3,3	-1	12,0/8,0	1450	1	1550	1	61,6	1	0,9
235	LP+070	1	M	10	1	16	0,21	32	1	16,5	1	75	6000	1	3700	1	2,8	-1	12,0/8,0	1450	1	1550	1	61,6	1	0,9
245	LP+090	1	M	3	1	24	1,83	80	1	40	1	185	6000	1	3400	1	8,5	-1	12,0/8,0	2400	1	1900	1	117,6	1	0,9
246	LP+090	1	M	4	1	24	1,62	90	1	45	1	190	6000	1	3400	1	9,5	-1	12,0/8,0	2400	1	1900	1	117,6	1	0,9
247	LP+090	1	M	5	1	24	1,55	90	1	45	1	190	6000	1	3400	1	9,5	-1	12,0/8,0	2400	1	1900	1	117,6	1	0,9
248	LP+090	1	M	7	1	24	1,47	90	1	45	1	190	6000	1	3400	1	9,5	-1	12,0/8,0	2400	1	1900	1	117,6	1	0,9
249	LP+090	1	M	10	1	24	1,43	80	1	40	1	190	6000	1	3400	1	8,5	-1	12,0/8,0	2400	1	1900	1	117,6	1	0,9

10(3040) Datensätze NO